

# ROOM CAPACITIES

Room	Area (m2)	Ceiling Height (m)	Booths (3x3m)	Theatre	Cocktails	Banquet	Dinner Dance	Cabaret	Classroom	Boardroom	U Shape	Hollow Square
<b>Exhibition Hall</b>												
Exhibition Hall (Total)	2000	9.0	120	1775	1775	1500	1400	1200	1000	—	—	—

<b>Royal Theatre</b>												
Royal Theatre (Total)	—	9.1	—	2448	—	—	—	—	—	—	—	—
Royal Theatre (Tiered)	—	4.6–9.1	—	1698	—	—	—	—	—	—	—	—
Royal Theatre (Flat floor)	749	9.1	—	780	1000	540	470	432	400	—	—	—

<b>Theatrettes</b>												
Bradman	360	3.2–4.4	—	287	—	—	—	—	—	—	—	—
Menzies	180	3.2–4.4	—	172	—	—	—	—	—	—	—	—
Nicholls	180	3.2–4.4	—	158	—	—	—	—	—	—	—	—
Sutherland	170	3.2–4.4	—	141	—	—	—	—	—	—	—	—

<b>Flat Floor Function Rooms</b>												
Ballroom (Closed)	658	4.5	30	500	500	500	440	360	370	—	96	108
Ballroom (Open)	762	4.5	30	—	650	580	520	—	—	—	—	—

<b>Gallery Rooms (Individual)</b>												
Torrens Room (T)	90	3.3	5	80	80	60	—	48	36	24	30	36
Swan Room (S)	155	3.3	10	140	140	80	80	64	48	36	30	36
Murray (M)	170	3.3	10	170	170	120	100	96	72	42	48	60
Fitzroy (F)	170	3.3	10	170	170	120	100	96	72	42	48	60
Derwent Room (D)	95	3.3	5	80	80	60	—	48	36	24	30	36

<b>Gallery Rooms (Combined)</b>												
TS Rooms	245	3.3	15	200	200	150	130	120	96	48	54	66
MF Rooms	340	3.3	20	368	368	240	210	192	156	—	84	104
FD Rooms	265	3.3	15	256	256	180	150	144	120	—	72	88
MFD Rooms	435	3.3	25	—	512	330	270	—	—	—	—	—

<b>Work Rooms</b>												
Boardroom 1	27	2.6	—	20	—	—	—	—	—	12	—	—
Boardroom 2	24	2.6	—	20	—	—	—	—	—	12	—	—
Executive Room	90	2.7	—	60	60	50	—	32	40	24	25	30

<b>Foyer Areas</b>												
Main Foyer	1100	3.4	—	—	800	—	—	—	—	—	—	—
Theatrette Foyer	400	3.8	—	—	200	—	—	—	—	—	—	—
Ballroom Foyer	300	5.3	—	—	200	—	—	—	—	—	—	—
Gallery Foyer	390	4.1	—	—	250	—	—	—	—	—	—	—

Royal Theatre - Concerts	Area (m²)	Ceiling Height	Booths	Tiered/ Theatre	General Admission (GA)	Flat floor seating	Total
Royal Theatre (Tiered + GA)	—	9.1	—	1698	1680	—	3378
Royal Theatre (Tiered + Flat Floor Seating)	—	4.6–9.1	—	1698	—	780	2478
Royal Theatre (GA on Flat floor)	749	9.1	—	—	2000	—	2000
Royal Theatre (Tiered + GA on Flat Floor)	—	4.6–9.1	—	1378	2000	—	3378

Please note: Capacity numbers listed are indicative only. Wheelchair accessibility has been included in capacity chart numbers listed.

The National Convention Centre Canberra is the perfect events venue, boasting premium facilities for every occasion.

Contact our Events Team on **(02) 6276 5200** or visit us online at **nccc.com.au**

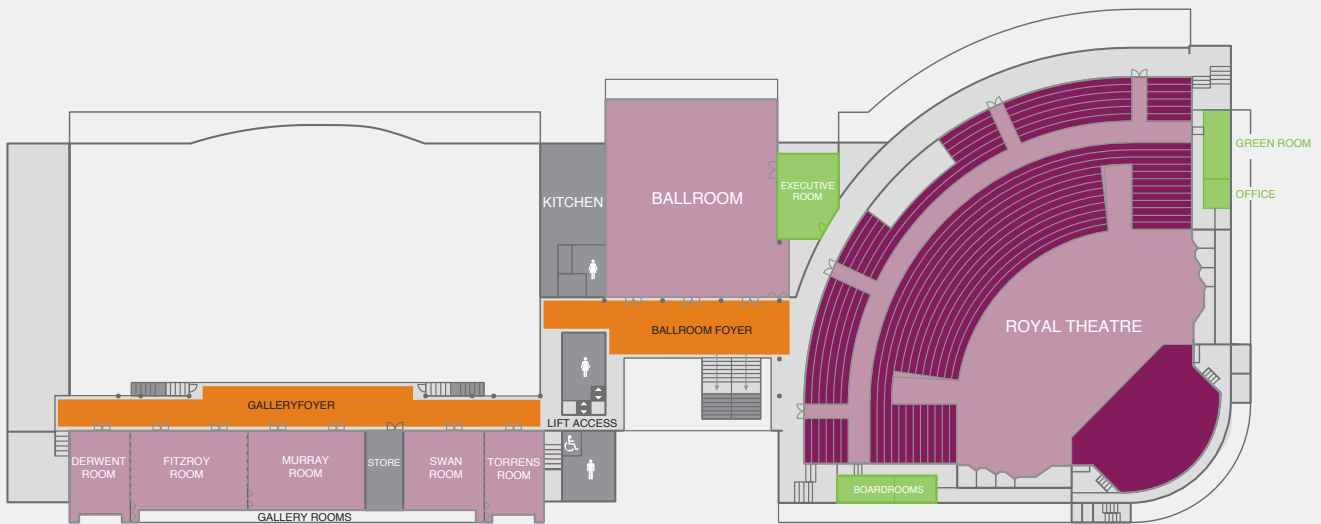

FIRST FLOOR

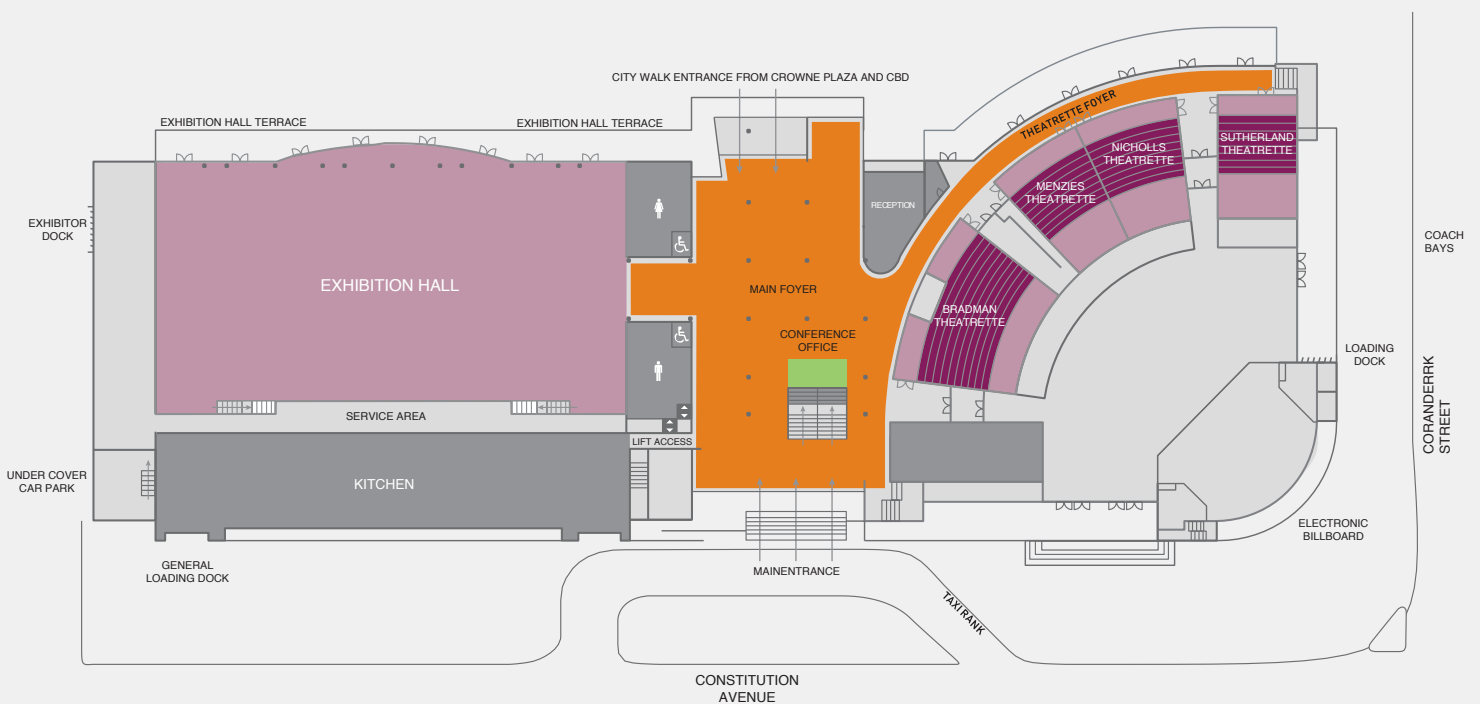

GROUND FLOOR

**KEY** MEETING AND EXHIBITION SPACES WORK ROOMS FACILITIES FOYER